

FLEXARM CVA-10 ASSEMBLER

WORKING RANGE 8"-28"

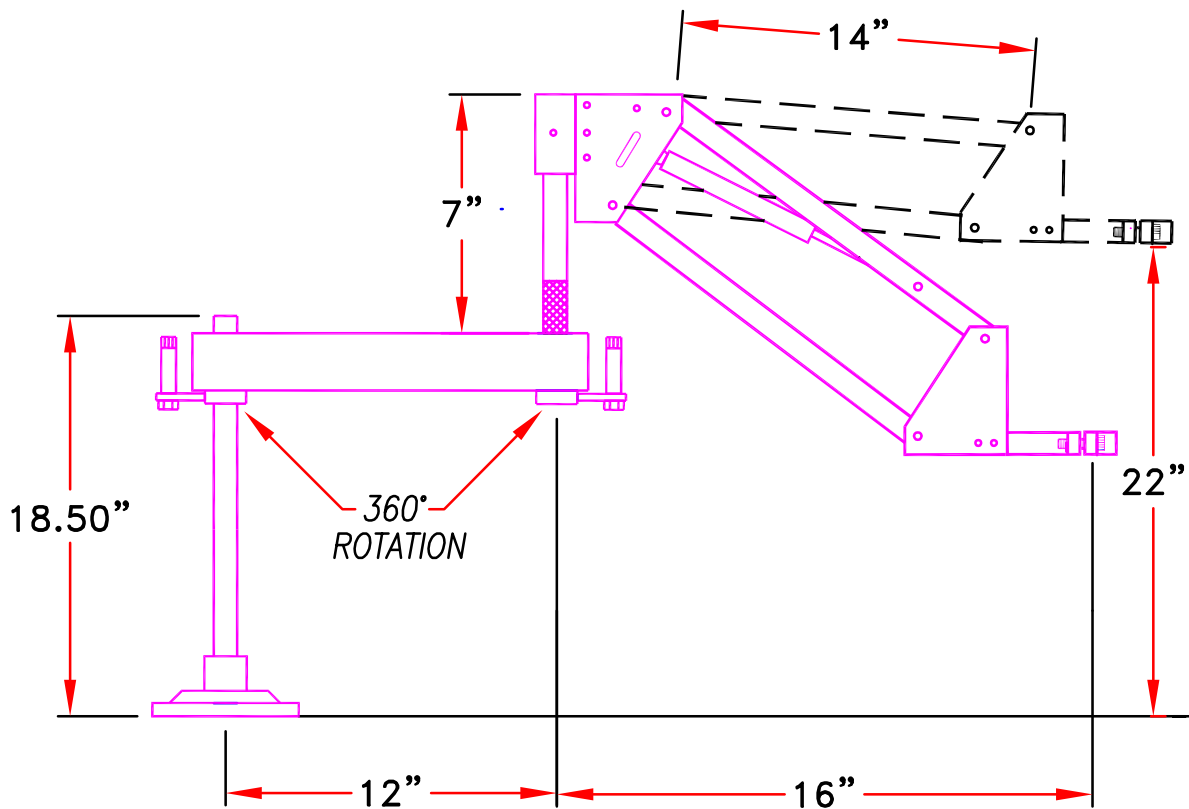

BASE MOUNT PATTERN

#0.406- 4 PLCS - EQUALLY SPACED
ON ϕ 4.500 BOLT CIRCLE

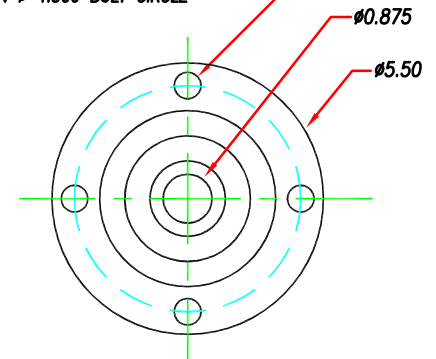

- * STANDARD MOUNT ACCOMMODATES 1"-2" DIAMETER TOOLS.
- * PROVIDE TOTAL WEIGHT TO COUNTER BALANCE WHEN ORDERING
- * MAX CAPACITY IS 12#